





Bring your vision to life...

Keystone Hardscapes® has been a leading developer of interlocking concrete pavers since the 1980s. Our unique and innovative pavers have been designed and installed in some of the most distinguished commercial spaces.

We are committed to rigorous internal research and development, ensuring Keystone Hardscapes pavers are able to withstand the unique demands of a commercial site. Available in a wide array of colors, finishes, shapes and sizes, we have pavers to meet the design needs of any pedestrian or vehicular application.

In addition, Keystone Hardscapes also offers a variety of design tools and services to ensure the success of every project.

Structural retaining walls are where Keystone began. Keystone's retaining wall systems continue to be trusted by engineers, architects and contractors worldwide to provide the best site solutions for commercial, municipal, industrial, transportation/DOT and residential applications.

Locally made products, nationally trusted brand. Trust us to help you bring your next commercial project to life.

keystonehardscapes.com

ON THE COVER:

DENVER INTERNATIONAL AIRPORT - Denver, CO

Products & Colors: Holland, Holland II, CityStone™ 8x8 and 12x12 in Charcoal, Light Almond, Pewter and Wembley Tan
Finishes: Arctex™ and Standard **Landscape Architect:** Studio Insite **Paver Contractor:** Rocky Mountain Hardscapes

Table of Contents

Section One: Paver Applications.....	4-5
Paver Finishes	6
Carriage Stone / Holland Stone	7
CityLock®	8-11
CityScape Hexagon	12-13
CityScape Symetry	14-15
CityScape Pentagon	16-17
CityStone™	18-28
Granette Setts	29
Holland Stone.....	30-40
Panorama™	41-43
Venetian®	44-45
Verona™	46-56
Vintage Stone®	57
 Section Two: Permeable Paver Applications	 58-59
Eco-CityLock®	60-71
Eco-Panorama™	72-73
Eco-Porta™	74-75
Eco-Venetian®	76-77
 Section Four: Wall Applications	 78-79
Broadstone®	80-83
Regalstone®	84-85



Find our latest product information at:
keystonehardscapes.com



TRANSPORTATION AUTHORITY - Corpus Christi, TX

Products & Colors: CityStone™ 8x8 and 12x12 in Caststone, Charcoal, Pewter and Slate **Finishes:** Standard

Architect: Gignac Architects **Landscape Architect:** Gignac Landscape Architects **Paver Contractor:** Paver Connection

Paver Finishes

Our pavers provide enduring beauty with unlimited design flexibility. The breadth of our portfolio is supported by our dedication to product quality, performance and customer service. Regardless of your space and application needs, our collection of pavers offers a wide variety of colors, patterns, sizes and textures to handle the project. Speak with your local Keystone Hardscapes representative to confirm in-stock options for your market.



STANDARD
Classic, through-mix surface



EMBOSSED
Natural flagstone appeal



SPLIT
Timeless appearance of natural granite



TUMBLED
Well-weathered charm



ANTIQUED
Worn and gracefully aged



PLATINUM
Facemix design offers superior color, texture and endurance



ARCTEX™
Shot blast process removes surface layer to create texture and reveal inner aggregates



ARCTEX™ PLATINUM
Facemix adds another level of color contrast and dimension

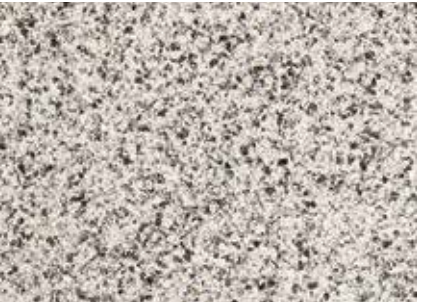

QUARTEX™
Exposed specialty aggregate surface utilizes options of natural granite, quartz and obsidian



CARRIAGE STONE / HOLLAND STONE

RAMBLER ROAD - Dallas, TX
Products & Colors: Carriage Stone and Holland Stone in Custom Color and Tan **Finishes:** Split and Standard
General Contractor: McMahon Contracting **Paver Contractor:** SYB Construction



CITYLOCK



CENTRO PLAZA AT VIA VILLA - San Antonio, TX

Products & Colors: CityLock® 4x16 in Caststone and Special Blend **Finishes:** Platinum
Architect: Ford, Powell & Carson **Landscape Architect:** Bender Wells Clark Design **Paver Contractor:** Gratr Landscape



CITYLOCK

COAL CREEK PARK - ERIE, CO
Products & Colors: CityLock® 4x12 in Charcoal, Limestone & Lt. Pewter **Finishes:** Standard
Landscape Architect: Wenk Associates **Paver Contractor:** Stone Creek Hardscapes



CITYLOCK

PERSONAL RESIDENCE - Grapevine, TX
Products & Colors: CityLock® 4x16 in Charcoal **Finishes:** Facemix
Landscape Architect/Architect/ Engineer of Record: Spear's Design **Paver Contractor:** Pavepro



CITYSCAPE HEXAGON

LINDEN STREET - Ft. Collins, CO
Products & Colors: Cityscape™ Hexagon



CITYSCAPE HEXAGON

MKT MIXED USE - Houston, TX
Products & Colors: Cityscape™ Hexagon Saturated in Charcoal and Caststone Finishes: Shotblast
Landscape Architect / Architect / Engineer of Record: SWA Group Paver Contractor: Gulf Coast Pavers



CITYSCAPE SYMETRY

JONQUIL APARTMENTS - Smyrna, GA
Products & Colors: CityScape Symetry and CityStone™ 6x6 in Charcoal and Chicago Blend **Finishes:** Standard
Architect: Geheber Lewis Associates **Landscape Architect:** B+C Studio **Paver Contractor:** The Landscape Guys





CITYSCAPE PENTAGON

CONFLUENCE PARK - San Antonio, TX

Products & Colors: CityScape Pentagon, Custom Caststone **Finishes:** Standard
Architect: Lake / Flato **Landscape Architect:** Rialto Studio **Paver Contractor:** Cribley Enterprises



CITYSCAPE PENTAGON

CONFLUENCE PARK - San Antonio, TX

Products & Colors: CityScape Pentagon, Custom Caststone **Finishes:** Standard
Architect: Lake / Flato **Landscape Architect:** Rialto Studio **Paver Contractor:** Cribley Enterprises



CITYSTONE

GAS SOUTH DISTRICT - Duluth, GA

Products & Colors: CityStone™ Demi & 12x12 in Charcoal, Graphite and Pewter **Finishes:** Standard

Landscape Architect: Lose Design **Paver Contractor:** Brightview Landscape

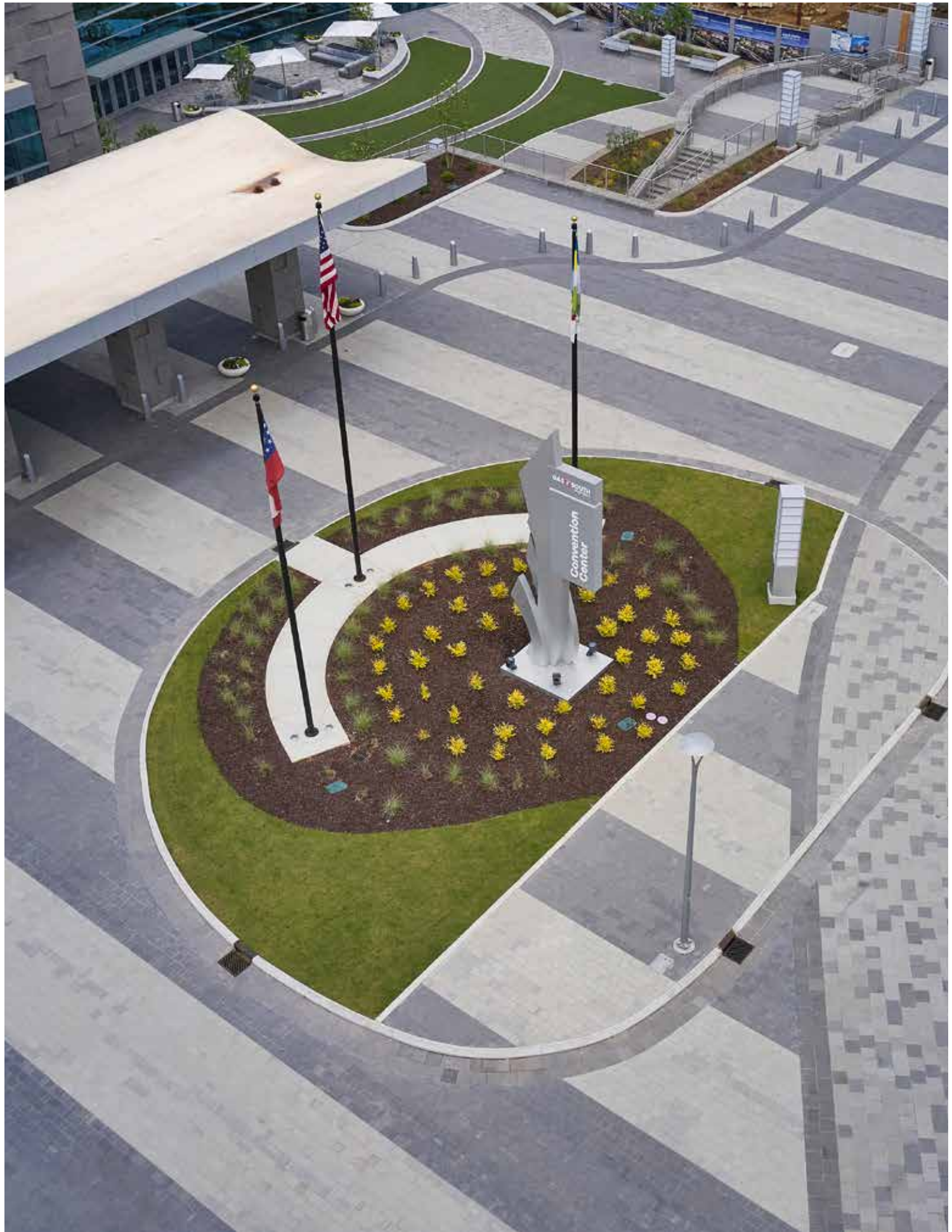

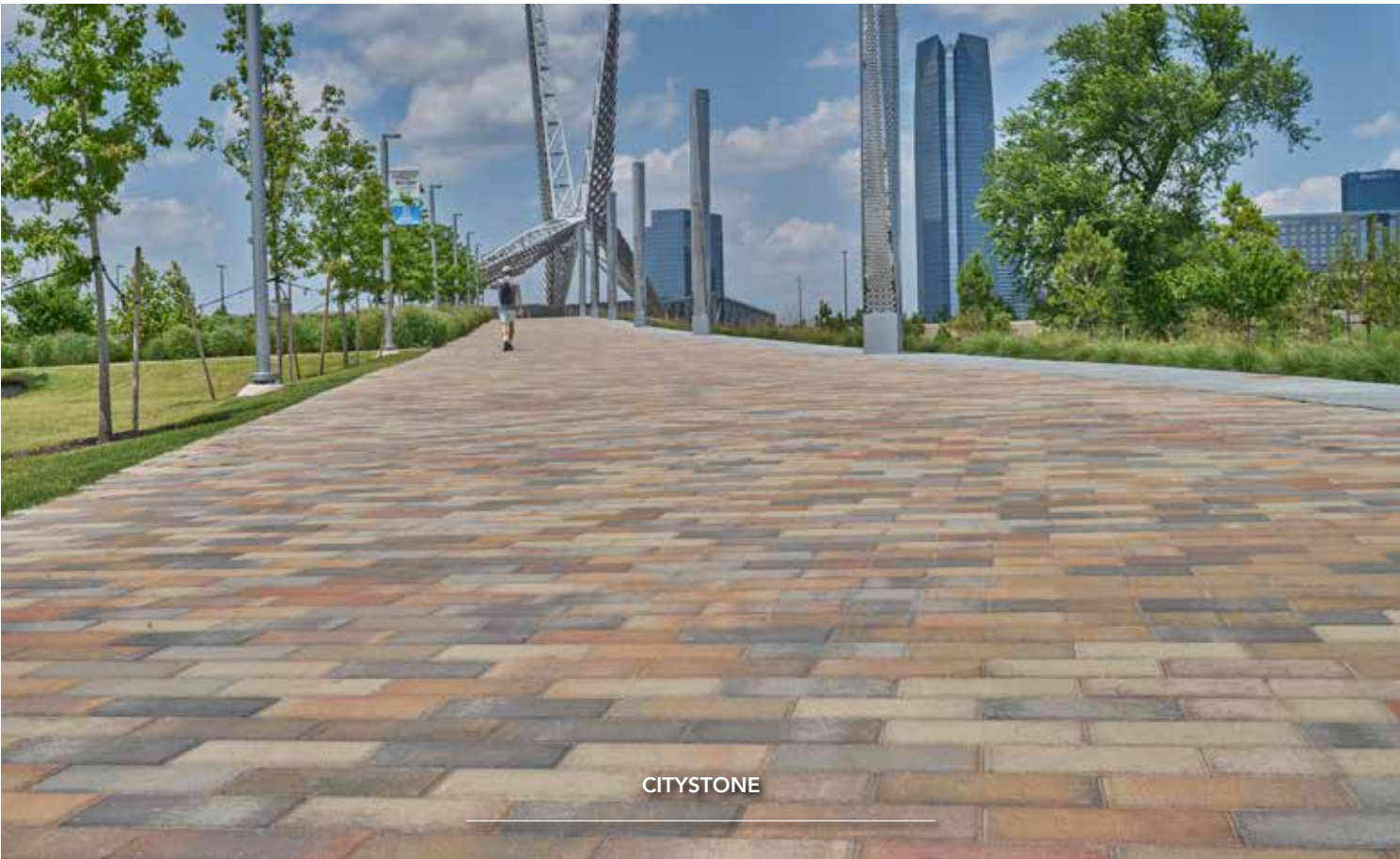

SCISSOR TAIL PARK - Oklahoma City, OK
Products & Colors: CityStone™ 6x12 in Milsap, Antique Pewter, Old Town Blend, Gold Rush and Texoma Blend **Finishes:** Standard
Landscape Architect: Hargreaves Jones **General Contractor:** Winn Construction **Paver Contractor:** Onsite Construction



MERCEDES-BENZ STADIUM - Atlanta, GA
Products & Colors: CityStone™ 6x12 and Holland Stone in Caststone, Charcoal and Pewter **Finishes:** Standard
Landscape Architect: HGOR **Paver Contractor:** Brightview Landscape



CITYSTONE



DOT CAMPUS - Austin, TX
Products & Colors: CityStone® 3x12 in Schlegel Tan, CityStone® 6x12 in Tan **Finishes:** Standard / Shotblast
Landscape Architect / Architect / Engineer of Record: Coleman & Associates **Paver Contractor:** AIM Paving

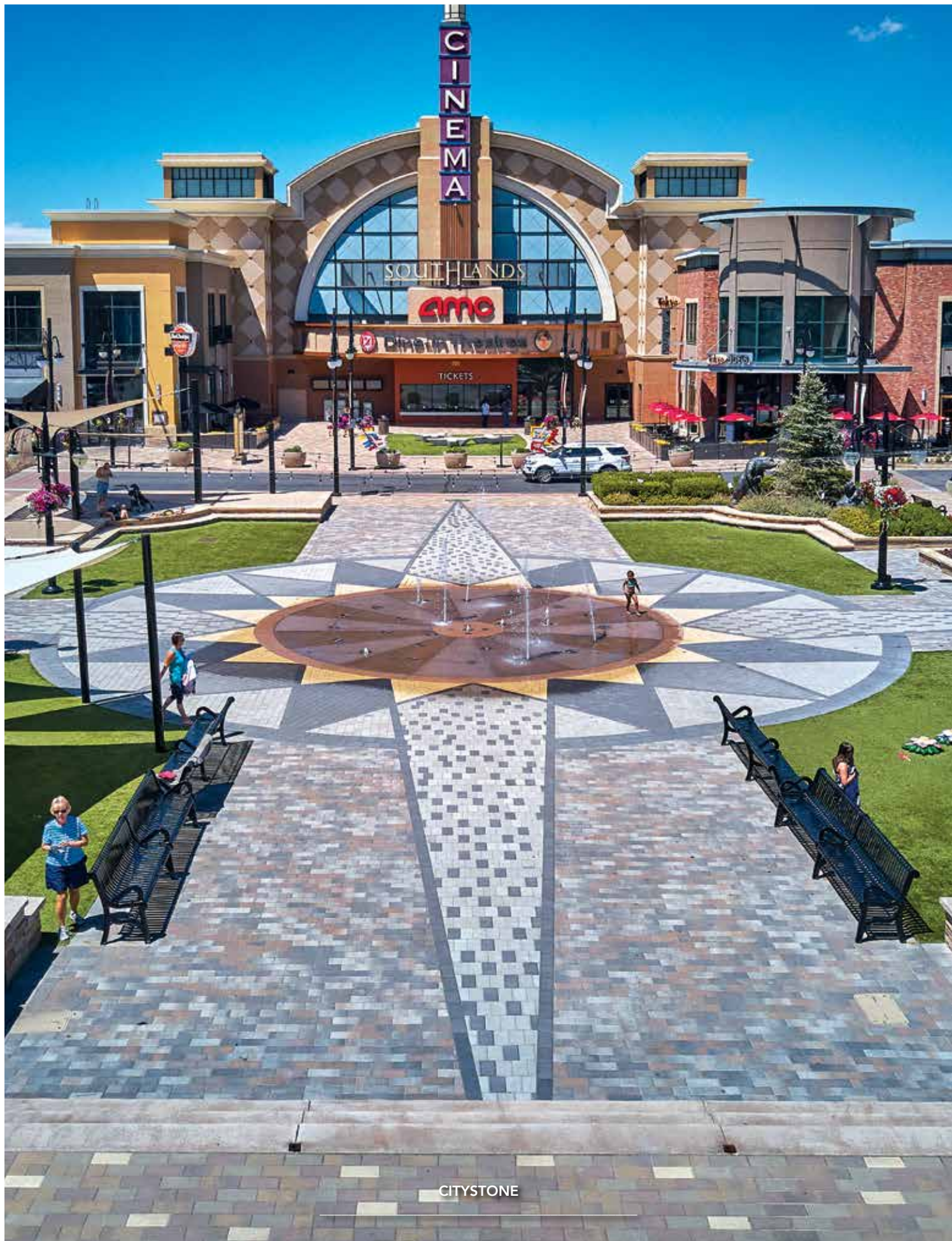

SOUTHLANDS MALL - Aurora, CO
Products & Colors: CityStone™ and Verona™ in Antique Savannah, Charcoal, Light Brown, Slate, Southlands Blend, Tan and Wemby Tan **Finishes:** Standard
Landscape Architect: Studio Insite **General Contractor:** Rigeline Construction **Paver Contractor:** Continental Hardscape Systems



OVATION SENIOR APARTMENTS - Las Vegas, NV
Products & Colors: CityStone™ Series 12x12, 6x12, 6x9, 6x6 and 3x6 in Pacific Tan and Santa Barbara Blend **Finishes:** Standard
Paver Contractor: Brazilian Pavers

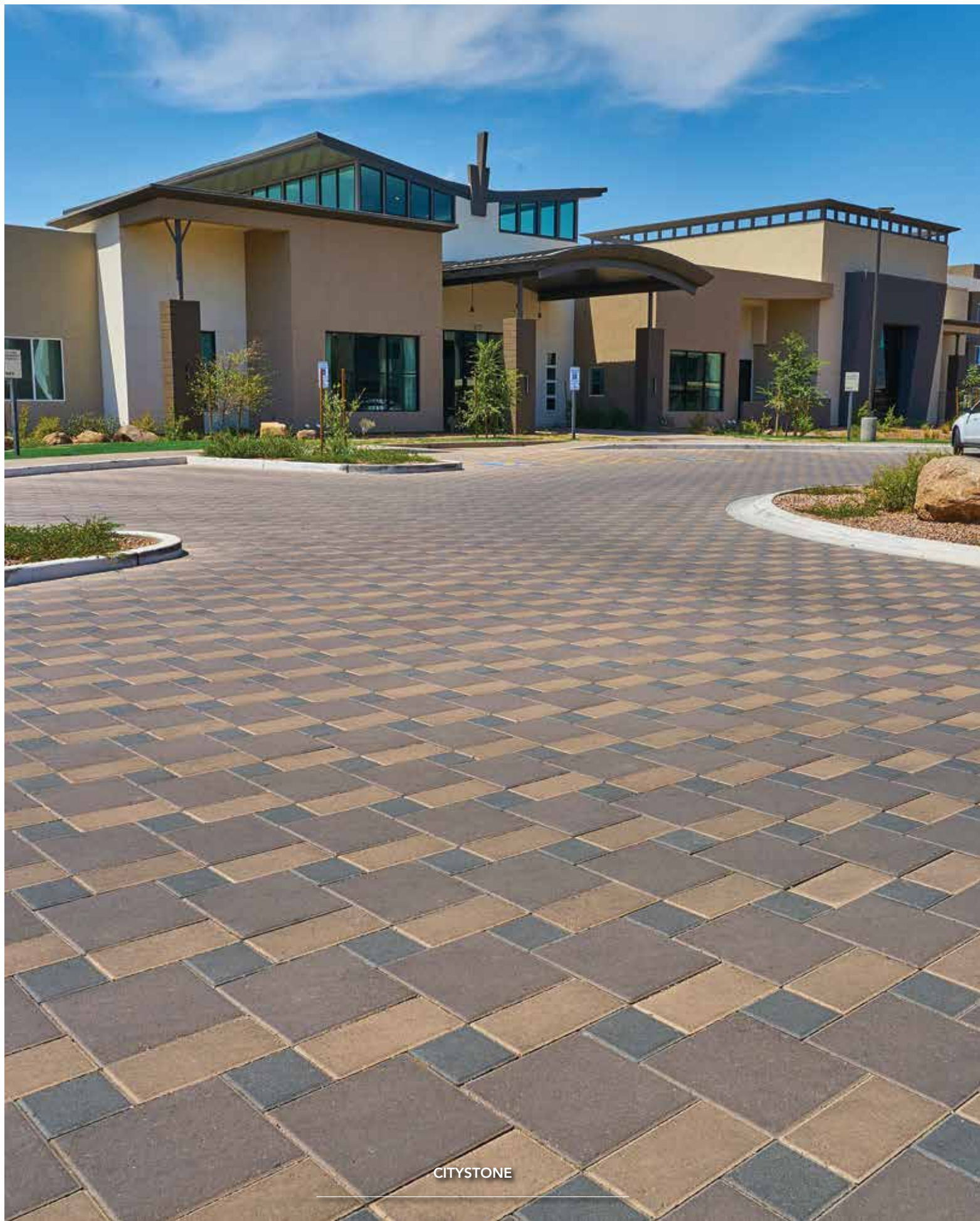

CITYSTONE

CHANDLER AIR PARK - Phoenix, AZ

Products & Colors: CityStone™ 6x6, 6x12 and 12x12 in Charcoal, Dark Brown and Tan **Finishes:** Standard
Paver Contractor: AME Landscape

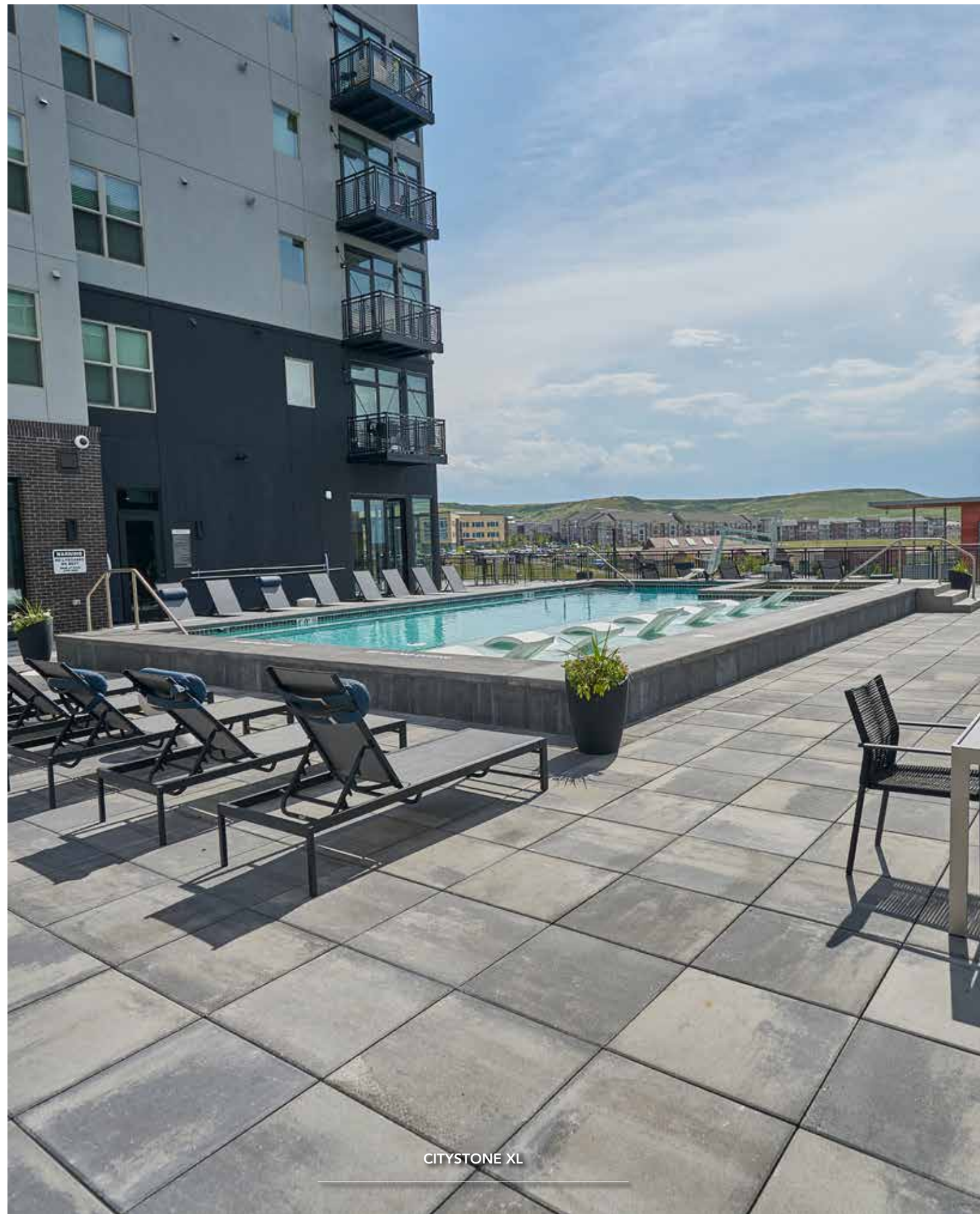

CITYSTONE XL

NOVUS SKY RIDGE - Lonetree, CO

Products & Colors: CityStone™ XL 24x24 Pedestal Set in Gunsmoke **Finishes:** Facemix
Landscape Architect: BSB Design **Paver Contractor:** Alpha Roofing



OMNI PGA - Frisco, TX
Products & Colors: Symmetry Square, CityStone™ II, CityStone™ I, Carriage Stone in Antique Pewter and Charcoal **Finishes:** Facemix
Landscape Architect: Studio Outside **Paver Contractor:** Pavepro



BRAVES PEDESTRIAN BRIDGE - Atlanta, GA
Products & Colors: Granette Setts in Chicago Blend **Finishes:** Tumbled
Architect: Wakefield Beasley & Associates **Landscape Architect:** HGOR **Paver Contractor:** JLL Construction



HOLLAND STONE

COURTYARD BY MARRIOTT - Houston, TX

Products & Colors: Holland Stone in Charcoal, Limestone, Pewter and Tan **Finishes:** Standard
Landscape Architect: Askaura Robinson **Paver Contractor:** Paver Connection

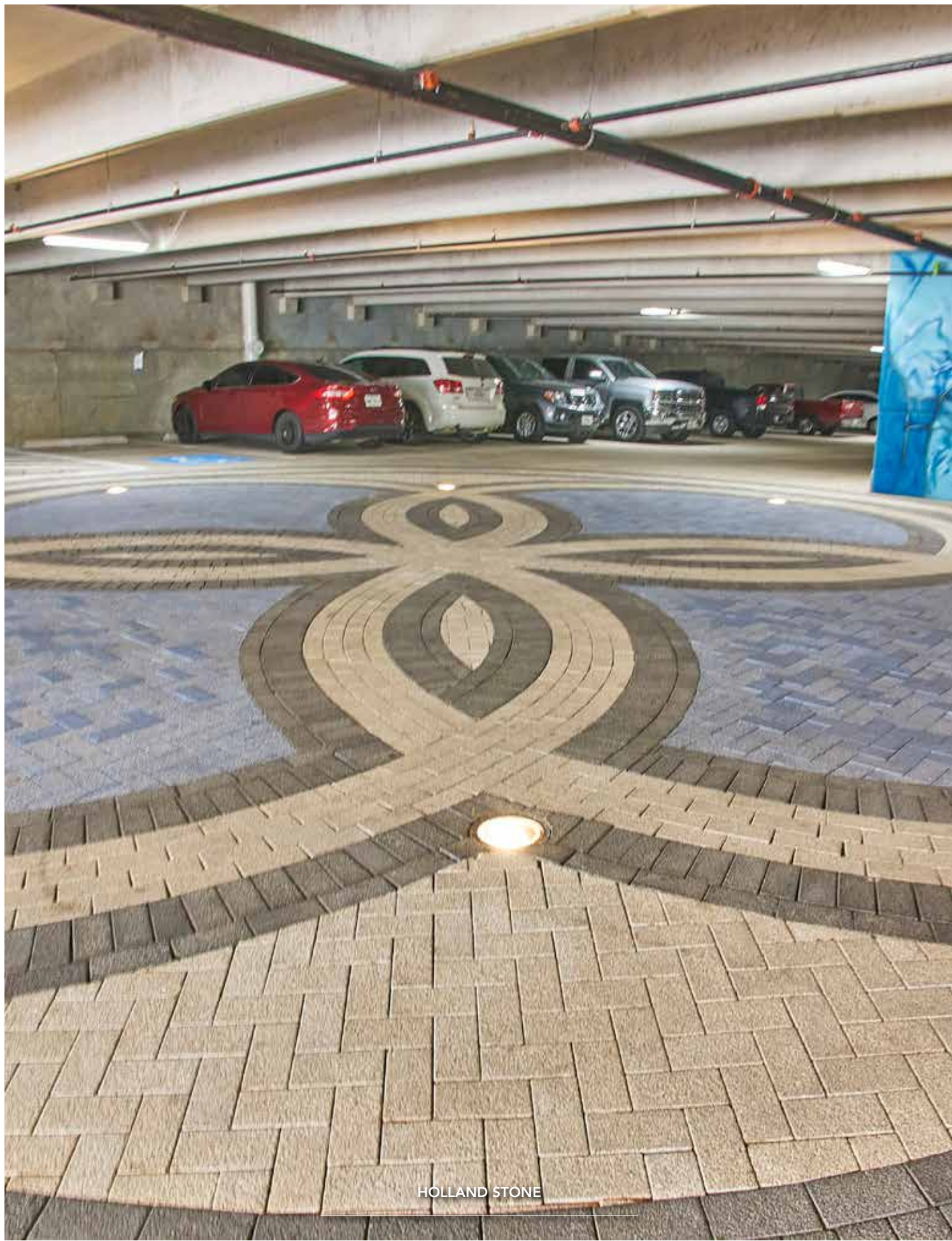

HOLLAND STONE

LEGACY LAKESHORE - Irving, TX

Products & Colors: Holland Stone in Charcoal, Crystal, White and Blue **Finishes:** Quartex
Landscape Architect / Architect / Engineer of Record: DCBA Landscape Architecture **Paver Contractor:** Arlington Pavers



HOLLAND STONE



TEXAS LIVE ARENA - Arlington, TX

Products & Colors: Holland Stone, Holland II and CityStone™ (Parkway Series) in Antique Brown, Antique Pewter, Custom Antique Terra Cotta and Old Town Blend **Finishes:** Arctex™ and Standard **Landscape Architect:** Hord Coplan Macht - Baltimore, MD and SWA Group - Dallas, TX **Paver Contractor:** AIM



HOLLAND STONE

TEXAS RANGERS STADIUM - Arlington, TX

Products & Colors: Holland Stone in Caststone, Charcoal and Slate **Finishes:** Standard, Arctex

Landscape Architect / Architect / Engineer of Record: Hord Coplan Macht & SWA Group **Paver Contractor:** AIM Construction

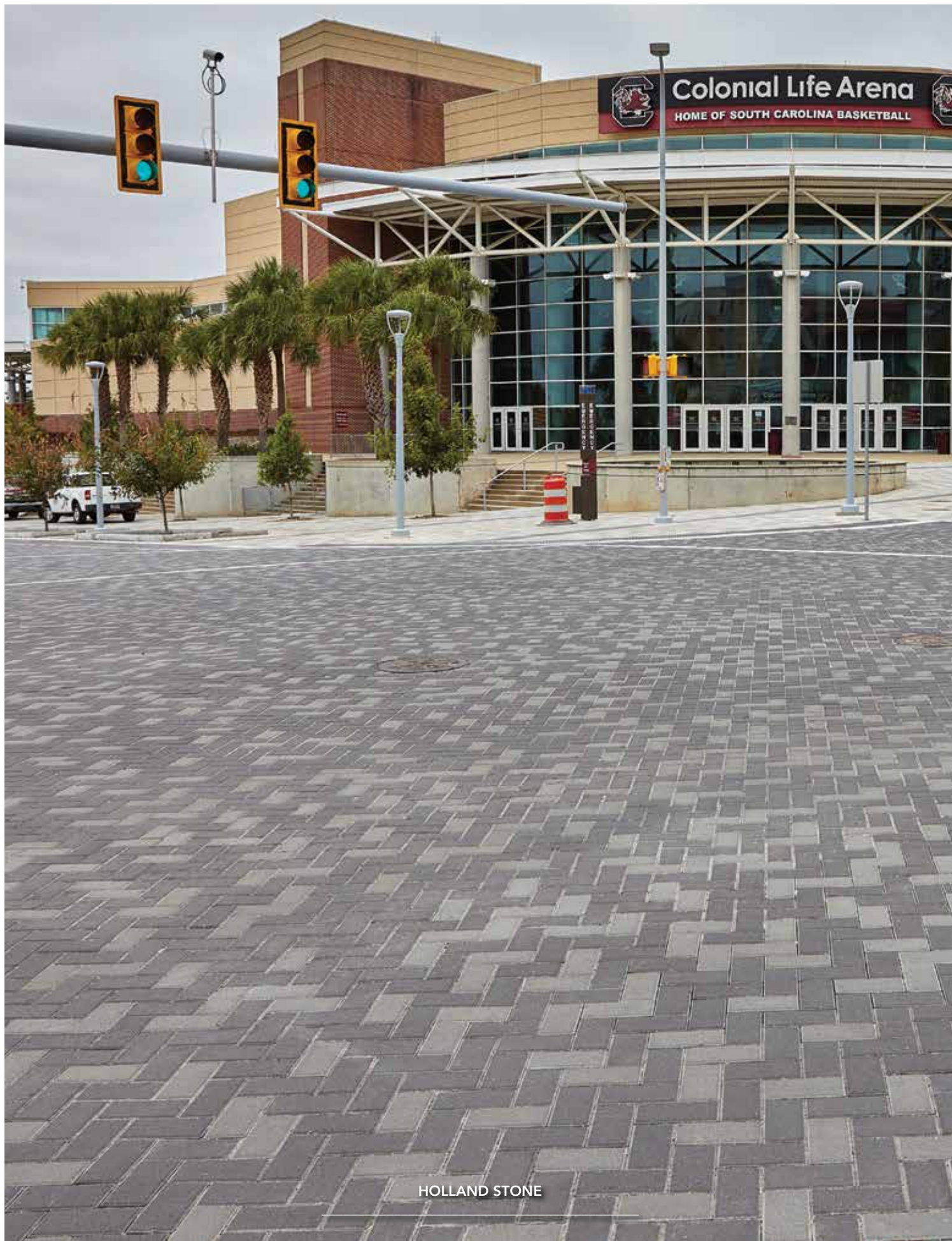

HOLLAND STONE

COLONIAL LIFE ARENA - Columbia, SC

Products & Colors: Holland Stone in Charcoal and Slate Blend **Finishes:** Standard

Paver Contractor: Perrin Babb



HOLLAND STONE

SPANISH PLAZA RENOVATION - New Orleans, LA
Products & Colors: Holland Stone (Parkway Series) in Blue, Charcoal and Pewter **Finishes:** Standard
Landscape Architect: Dana Brown & Associates **Paver Contractor:** LA Pavers





HOLLAND STONE



THE FOUNDRY - Loveland, CO
Products & Colors: Holland Stone in Charcoal, Pewter and Slate **Finishes:** Standard
Landscape Architect: BHA Design **Paver Contractor:** Paver Designs by Sundown



HOLLAND STONE

LAMARQUE STREETSCAPE INTERSECTION - Lamarque, TX
Products & Colors: Holland Stone Antique Tan, Buff, Charcoal and River Red **Finishes:** Standard
Landscape Architect / Architect / Engineer of Record: Helm Design Group **Paver Contractor:** Promodular Hardscapes



PANORAMA

MURPHY LANE - Newnan, GA
Products & Colors: Panorama™ Supra in River Blend **Finishes:** Standard
Paver Contractor: A Abby Group

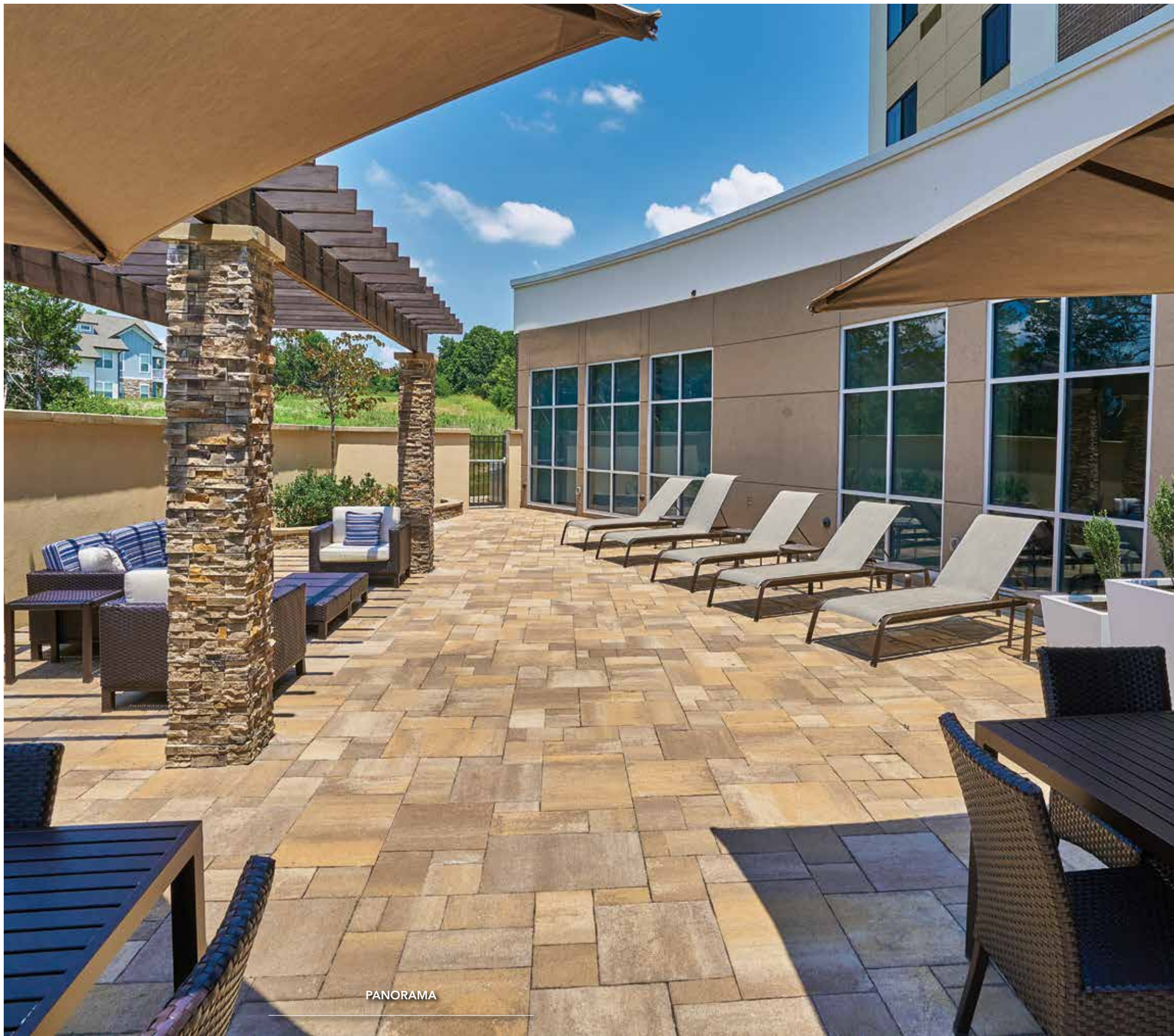

PANORAMA

COURTYARD HOTEL - Mt. Juliet, TN
 Products & Colors: Panorama™ Demi & Supra in Trinity Blend Finishes: Standard





VENETIAN

ANSLEY NEIGHBORHOOD TRAFFIC CALMING - Atlanta, GA
Products & Colors: Venetian® 6x12 in Chicago Blend **Finishes:** Tumbled
Landscape Architect: Site Solutions **Paver Contractor:** Astra Group



VENETIAN

CAROWINDS - Charlotte, NC
Products & Colors: Venetian® in Earth Blend **Finishes:** Standard
Paver Contractor: DRAW Enterprises



VERONA



DENVER PREMIUM OUTLETS - Thornton, CO
Products & Colors: Holland, Verona™ 6x18 and Verona™ 8x16 in Buff, Charcoal, Obsidian and Pewter **Finishes:** Arctex™ and Standard
Paver Contractor: Continental Hardscapes



VERONA

REX HILL WINERY - Newberg, OR
Products & Colors: Verona 3x18x100mm in LEED White, Medium Gray and Charcoal **Finishes:** Facemix
Paver Contractor: Ponce Northwest

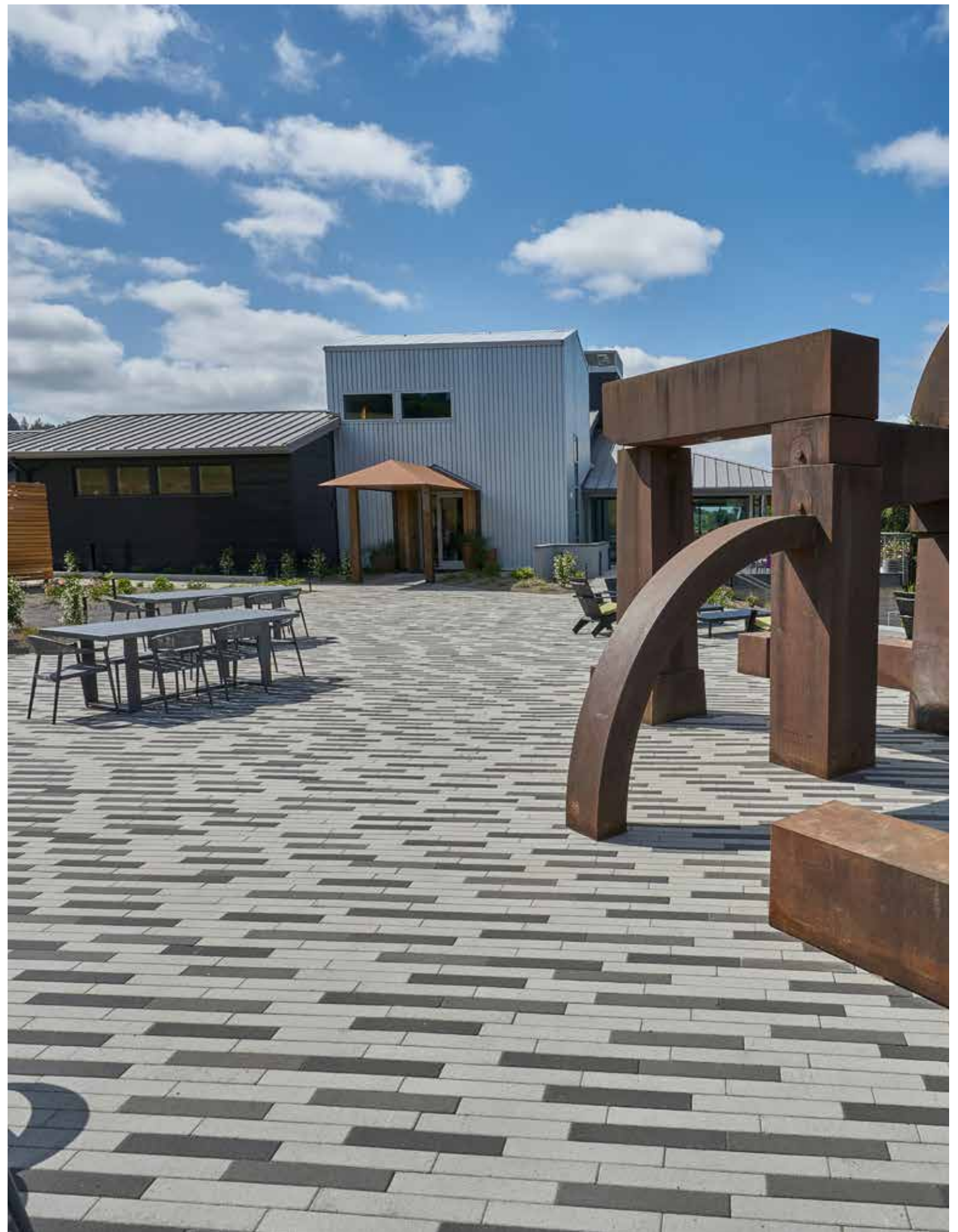

REX HILL WINERY - Newberg, OR
Products & Colors: Verona 3x18x100mm in LEED White, Medium Gray and Charcoal **Finishes:** Facemix
Paver Contractor: Ponce Northwest

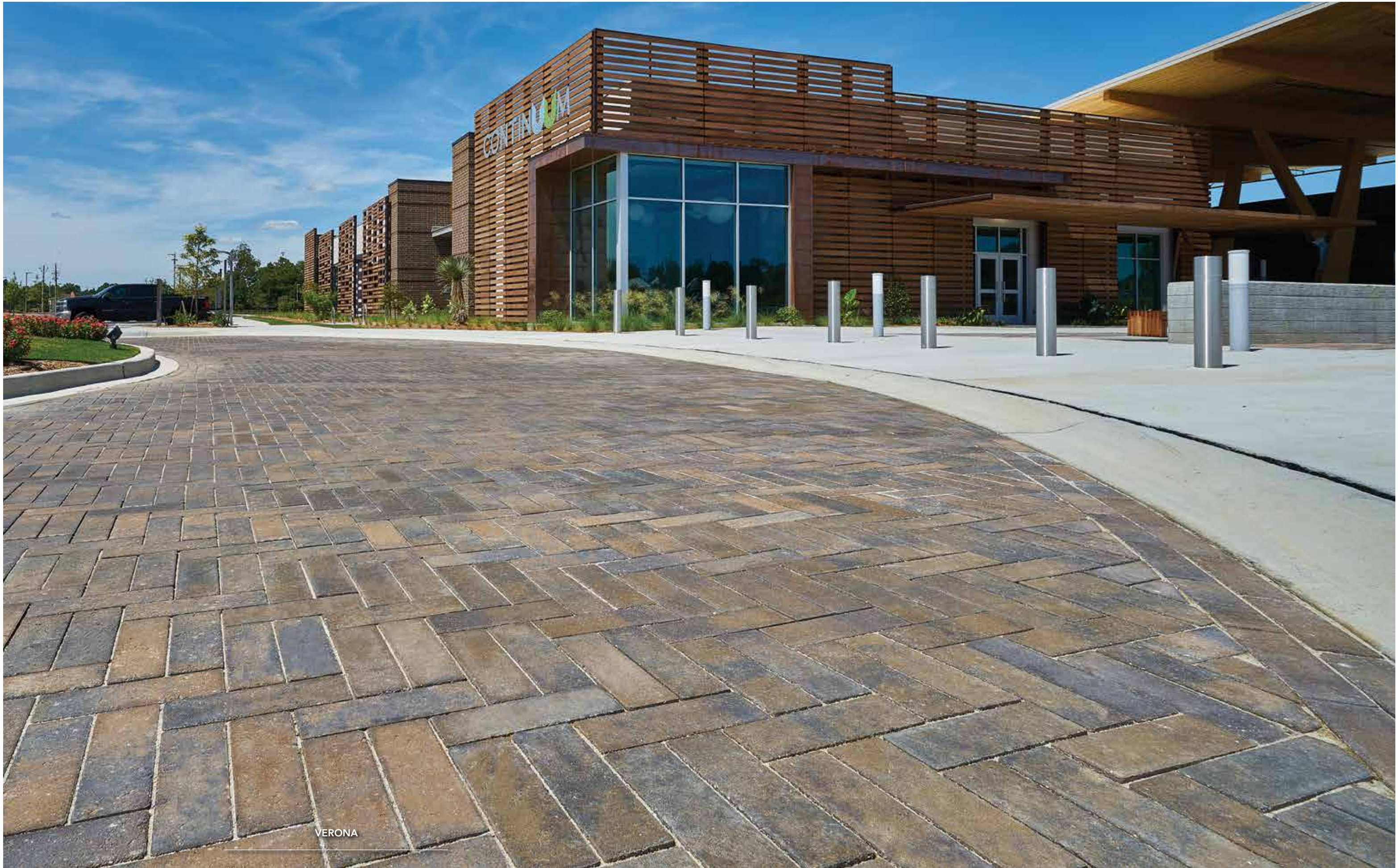

VERONA

CONTINUUM - Lake City, SC
Products & Colors: Verona™ 4x12 in Autumn Blend and Earth Blend **Finishes:** Standard
Landscape Architect: Seamon Whiteside **Paver Contractor:** Thompson Turner



DEERWOOD MULTI-FAMILY - Houston, TX
Products & Colors: Verona™ 3x18, Verona™ 9x18 Caststone and Pewter **Finishes:** Standard Pewter, Caststone Standard and Shotblast
Landscape Architect / Architect / Engineer of Record: Kimley-Horn **Paver Contractor:** Gulf Coast Pavers



FRISCO STATION - Frisco, TX
Products & Colors: CityStone 6x12, Holland II in Charcoal & Verona 3x18 **Finishes:** Standard
Paver Contractor: Gulf Coast Pavers

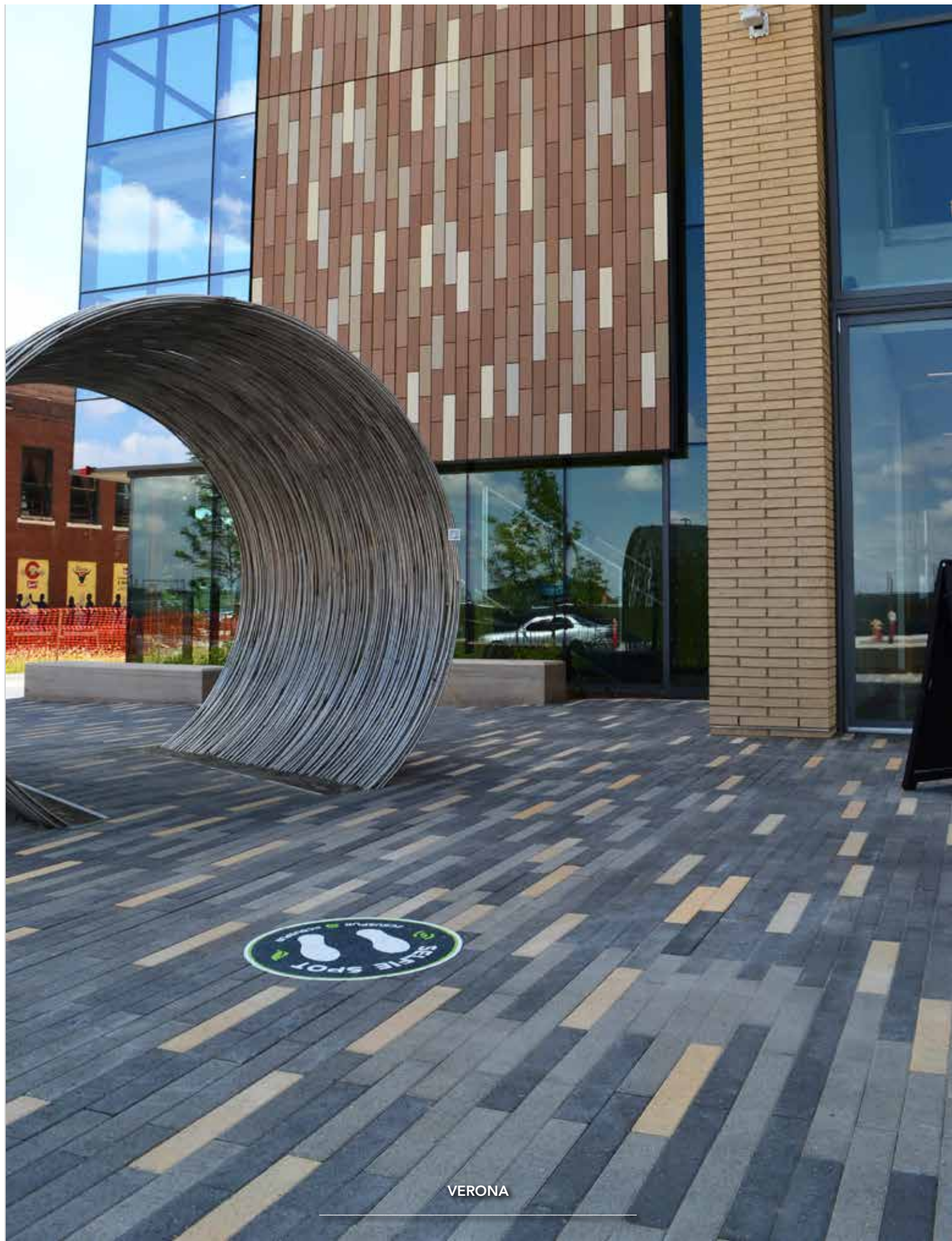

VERONA

NATIONAL WESTERN CSU FOOD - Denver, CO
Products & Colors: Verona 3x18 in Charcoal, Colorado Buff and Pewter **Finishes:** Standard
Landscape Architect Think Confluence **Paver Contractor:** Creative Hardscape



VERONA

THE SOUND - Irving, TX
Products & Colors: Verona™ 3x18, CityScape ADA Detectable Pavers and Holland Stone in Buff, Charcoal, Charcoal SP and Limestone OBS
Finishes: Platinum and Quartex™ **Landscape Architect:** StudioOutside **Paver Contractor:** PavePro

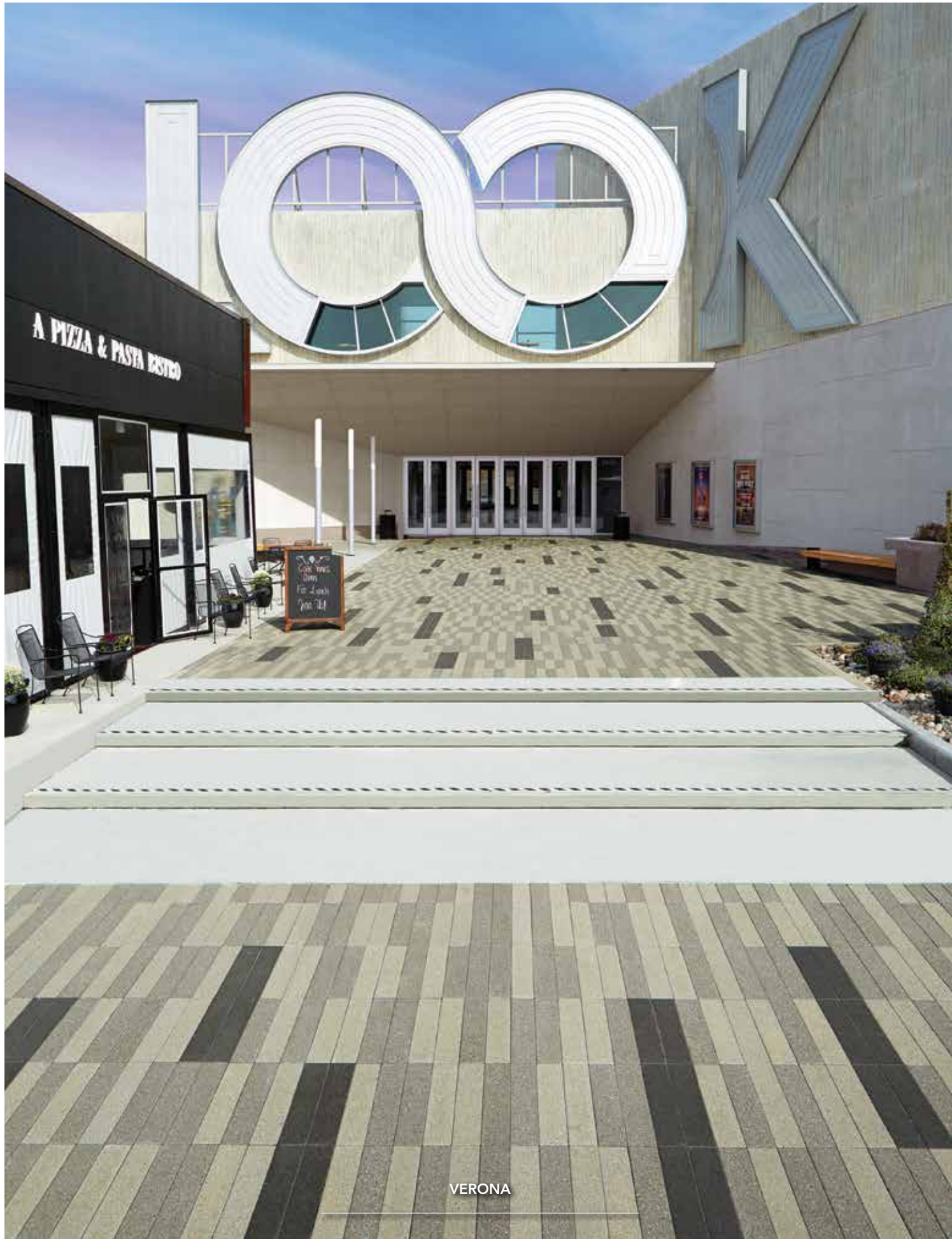

VERONA

LOOK THEATER - Dallas, TX
Products & Colors: Verona™ 5x24 in Pewter, Saturated Charcoal and Slate **Finishes:** Arctex™ and Standard
General Contractor: V.C.C. **Landscape Architect:** Studio Outside **Paver Contractor:** Arlington Pavers



VINTAGE STONE

PRIVATE RESIDENCE - Dallas, TX
Products & Colors: Vintage Stone® 3-pc Combo and 9x9 in Travertine **Finishes:** Standard
Paver Contractor: Hardscape Specialties



SECTION TWO

PERMEABLE

APPLICATIONS

CONFLUENCE PARK - Denver, CO
Products & Colors: Eco-CityLock® 5x10 and Holland Stone in Charcoal, Mesa Buff Slate, River Red and Pewter **Finishes:** Standard
Landscape Architect: Wenk Associates **Paver Contractor:** Stonecreek Hardscapes

Color(s) printed here are as true a match as the printing process will allow. For best matching results, please refer to actual samples.



ECO-CITYLOCK

BRENDA JILL GARCIA MEMORIAL - Katy, TX
Products & Colors: Eco-CityLock® 5x10 and Eco-CityLock® 4x8 in Charcoal, Limestone and Pewter **Finishes:** Standard
Engineer: BGE **Landscape Architect:** Murr Incorporated **Paver Contractor:** Gulf Coast Pavers



ECO-CITYLOCK

TRAVIS AT THE LAKE APARTMENTS - Austin, TX
Products & Colors: Eco-CityLock® Demi in Antique Buff, Antique Savannah and Café **Finishes:** Standard
Architect: Steinberg Dickey Collaborative **Landscape Architect:** Open Air Studio **Paver Contractor:** Tuscany Pavers



ECO-CITYLOCK

MUSEUM OF THE SHENANDOAH VALLEY - Winchester, VA
Products & Colors: Eco-CityLock® Demi **Finishes:** Face Mix
Landscape Architect: Kimley-Horn **Paver Contractor:** Arlington Pavers



ECO-CITYLOCK

GALVESTON COLLEGE- Galveston, TX
Products & Colors: Eco-CityLock® 5x10 in Antique Pewter **Finishes:** Standard
Engineer: Dally Associates **Paver Contractor:** Pro Pavers



ECO-CITYLOCK

WIGGLE NEIGHBORHOOD - San Francisco, CA
Products & Colors: Eco-CityLock™ 5x10 in Oaks Blend **Finishes:** Standard
Architect: City of San Francisco Public Works **Landscape Architect:** City of San Francisco Public Works **Paver Contractor:** Pacific Hardscapes



ECO-CITYLOCK

AUTOZONE - Franklin, TN
Products & Colors: Eco-CityLock® 5x10 in Chicago Blend **Finishes:** Standard
Landscape Architect: Civil Engineering Services, LLC



ECO-CITYLOCK

JORDAN AT THE MUELLER - Austin, TX
Products & Colors: Eco-CityLock® 4x8 in Antique Pewter and Antique Savannah **Finishes:** Standard
Landscape Architect: Studio Balcones **Paver Contractor:** Tuscany Pavers



ECO-CITYLOCK

THE RESERVE AT LAKE TRAVIS - Lake Travis, TX
Products & Colors: Eco-CityLock® 5x10 in Antique Pewter **Finishes:** Standard

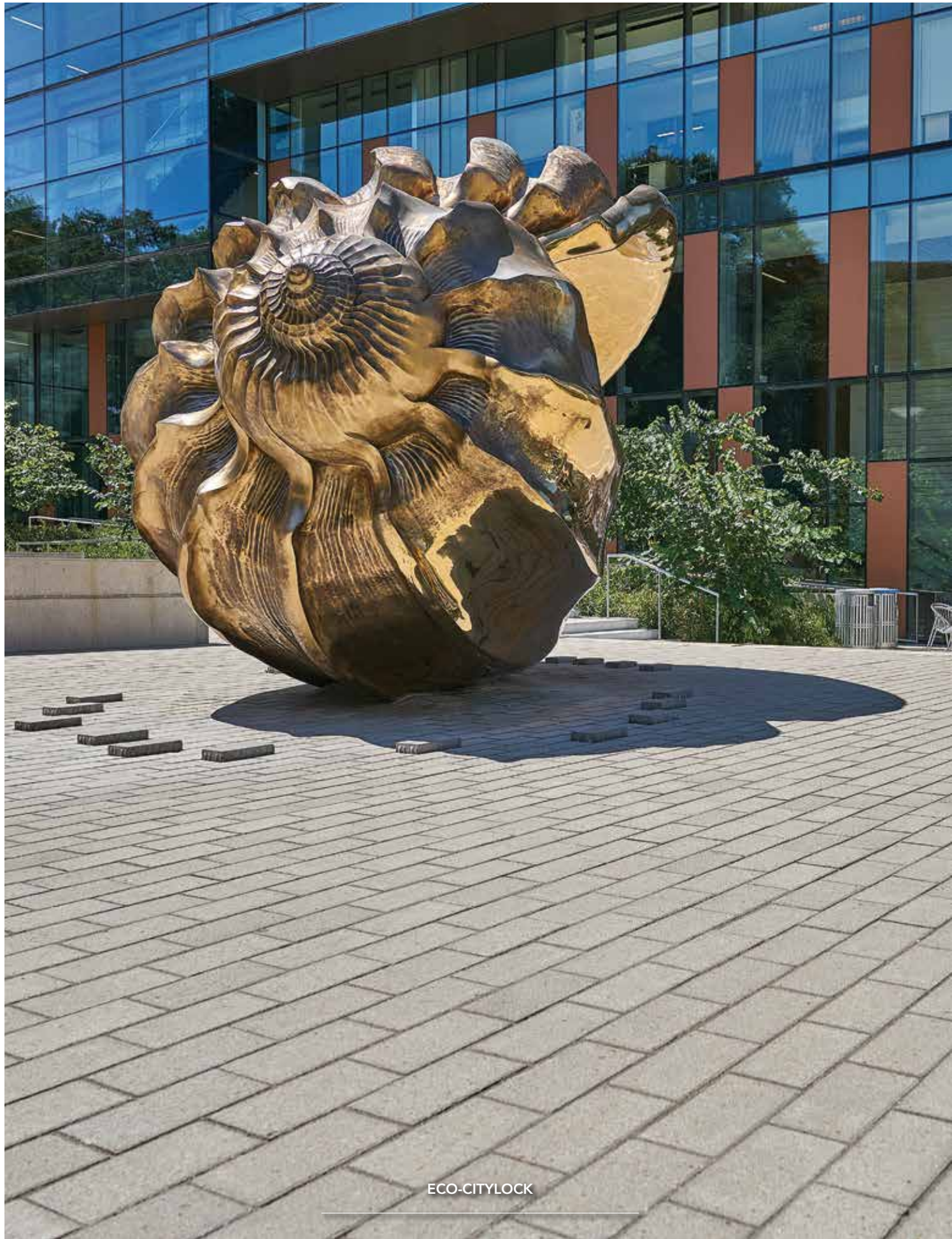

ECO-CITYLOCK

DELL SETON MEDICAL CENTER - Austin, TX
Products & Colors: Eco-CityLock™ 5x10 in Pewter **Finishes:** Standard
Architect: Sasaki **Landscape Architect:** Stantec **Paver Contractor:** Cleanscapes



ECO-CITYLOCK

ALSTON WAY - Berkeley, CA
Products & Colors: Eco-CityLock™ 5x10 in Oaks Blend **Finishes:** Standard
Engineer: AECOM **Paver Contractor:** European Paver Design



ECO-CITYLOCK

GOLDEN PEAK TO PLAINS - Golden, CO
Products & Colors: Eco-CityLock® L-10 Mech Lay in Breckenridge Blend **Finishes:** Standard
Landscape Architect: Stream Landscape Landscape Architecture & Planning **Paver Contractor:** Designs by Stonescapes



ECO-CITYLOCK

PORT MANCHAC - Akers, LA
Products & Colors: Eco-CityLock® 5x10 in Pewter **Finishes:** Standard
Engineer: AECOM **Paver Contractor:** Design Pavers

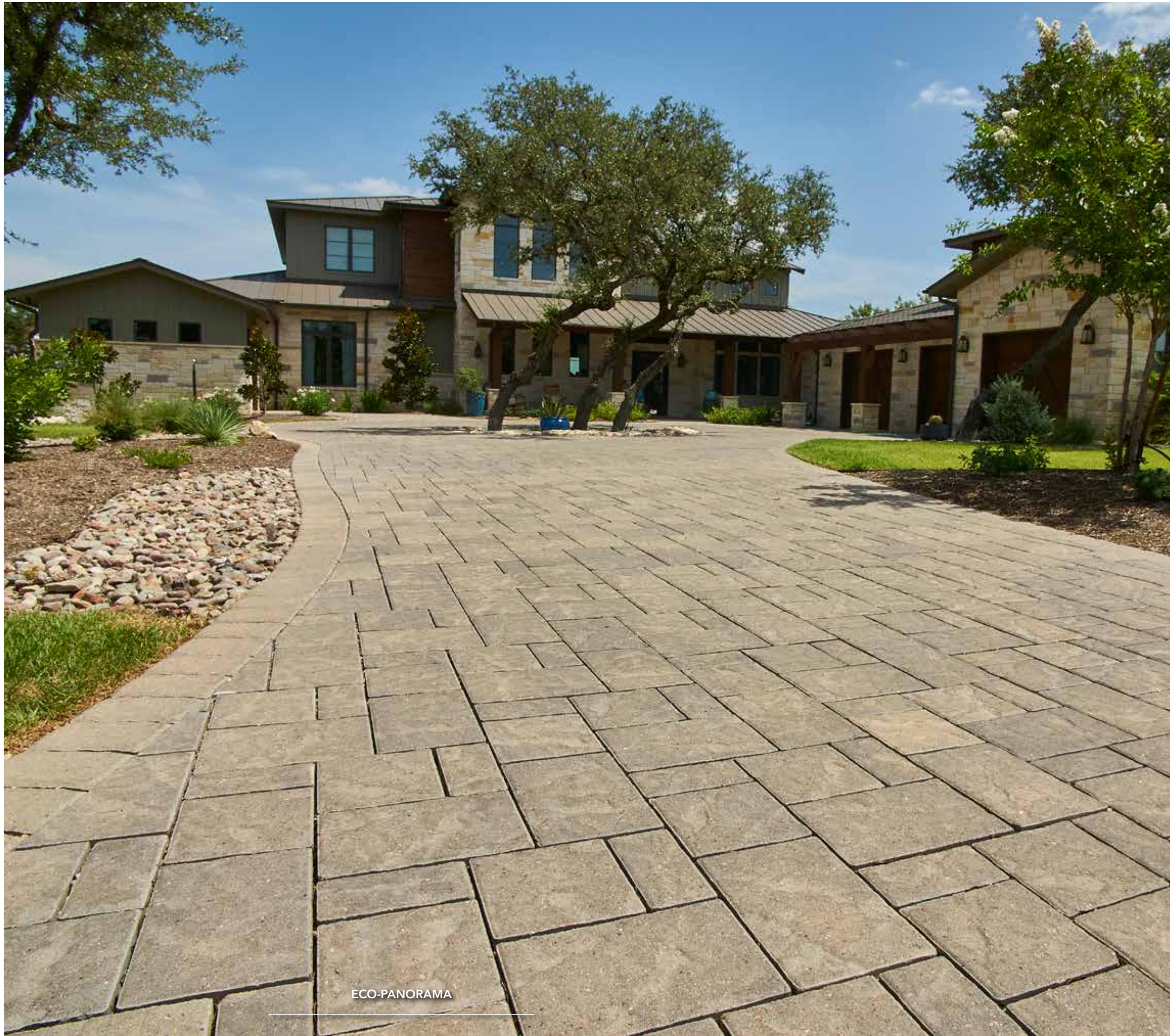

ECO-PANORAMA

PRIVATE RESIDENCE - Austin, TX
Products & Colors: Eco-Panorama™ Antique Tan **Finishes:** Standard





ECO-PORTA

APOGEE (DATCU) STATUS - Denton, TX

Products & Colors: Eco-Porta™ **Finishes:** Standard

Landscape Architect: Kaye Cook & Assoc. **Paver Contractor:** Pavepro



PIEDMONT PARK CONSERVANCY - Atlanta, GA
Products & Colors: Eco-Venetian® in Chicago Blend **Finishes:** Standard
Landscape Architect: HGOR **Paver Contractor:** Gibson Landscape

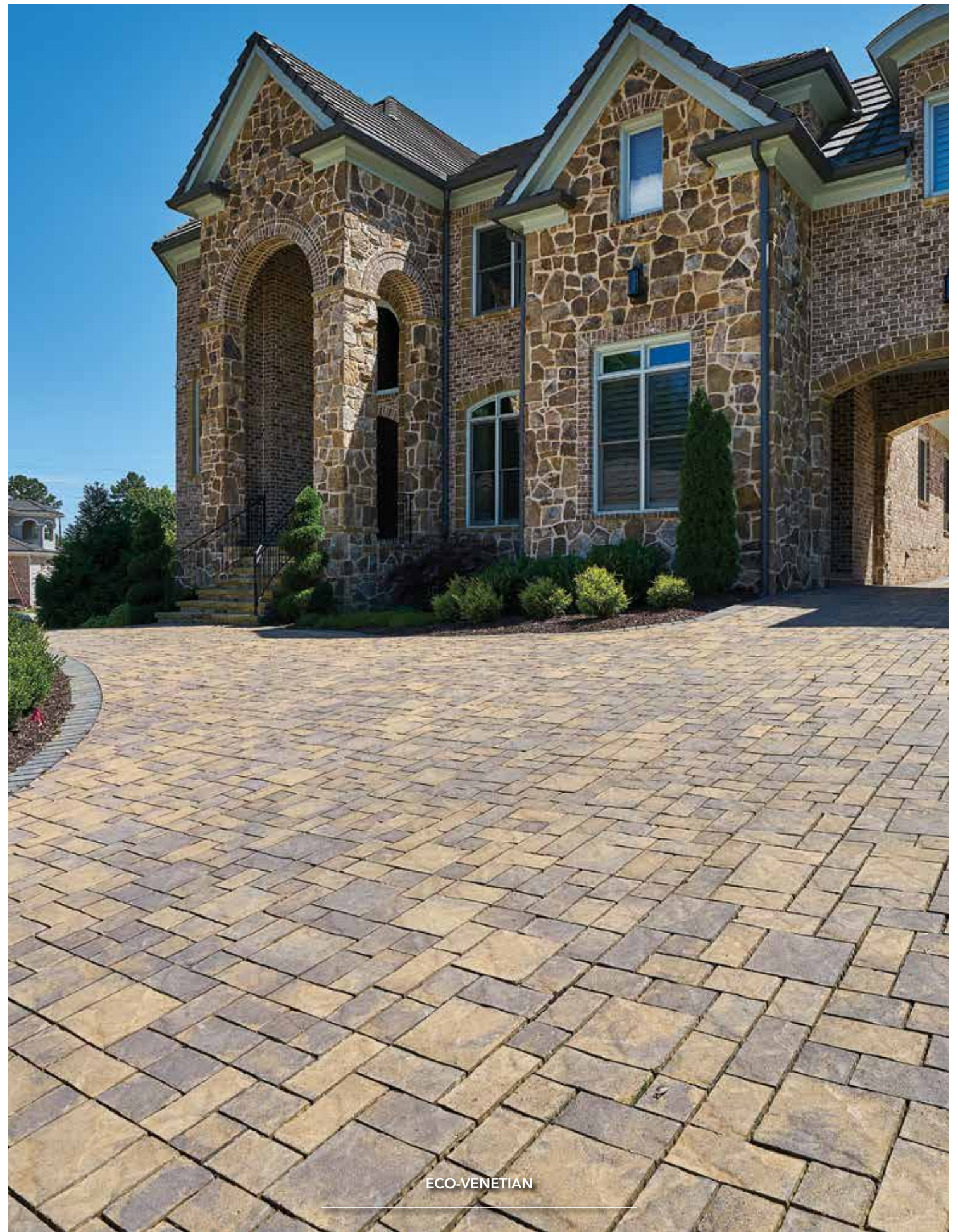

STONE HALL SUBDIVISION - Marietta, GA
Products & Colors: Eco-Venetian® and Eco-CityLock™ 5x10 in Chattanooga Sandstone **Finishes:** Standard
Paver Contractor: Green Village Landscaping



THE FALLS EVENT CENTER - Littleton, CO
Products & Colors: Regal Stone Pro™ in Prairie Brown Finishes: Rockface



BROADSTONE

DRURY PLAZA HOTEL - Cape Girardeau, MO
Products & Colors: Broadstone™ Adobe Blend **Finishes:** Rockface
Landscape Architect: IDA **Wall Contractor:** Bloomfield Road Landscape





I 20 LOGISTICS - Dallas, TX

Products & Colors: Broadstone™ Rockface Medley **Finishes:** Rockface

Wall Installation Contractor: JDK & Associates



REGALSTONE

POLICE DEPARTMENT - Thornton, CO
Products & Colors: Regal Stone® **Finishes:** Regal Pro Rockface
Landscape Architect: Self Designed **Installation Contractor:** Miller Wall





CHARLOTTE AVE APARTMENTS - Nashville, TN
Products & Colors: CityStone™ 12x12 and Plaza Stone Rectangle in Caststone and Chattanooga Sandstone **Finishes:** Standard
Architect: RJTR **Landscape Architect:** Ragan-Smith **Paver Contractor:** Worthing Southeast Builders

PRODUCT WARRANTY

LIMITED WARRANTY for the Contract Professional, Developer, or other Commercial Purchaser Keystone Hardscapes, having its headquarters located at Five Concourse Parkway, Atlanta, GA 30328, warrants its products at the time of delivery will meet or exceed the applicable ASTM standards on compressive strength and absorption if installed in accordance with applicable ICPI (www.icpi.org) or NCMA (www.ncma.org) standards. This warranty does not cover standard manufacturing variations, color variations/matching or efflorescence. Keystone Hardscapes is not responsible for installation of the product or defective conditions caused by installation, abuse, impact, abrasion or alteration of the product, earth-shifts, excessive or unforeseen site conditions, acts of God or application of de-icing salt or other chemicals to the product. Liability under this warranty, if the product is found to be defective, is limited to the replacement of the defective product, or at Keystone Hardscapes' option, the refund of the purchase price of the defective product. Keystone Hardscapes does not guarantee that the shape or color will be available in the future and will provide an alternate shape or color from its current product line as determined by Keystone Hardscapes at the time of an accepted warranty claim. This warranty is valid for the lifetime of the product. This warranty is transferable. In the event of a claim under this warranty, notice must be given to Keystone Hardscapes, together with original proof of purchase, at its headquarters by sending a letter to: Keystone Hardscapes a/s Warranties, Five Concourse Parkway, Atlanta, GA 30328.

THIS WARRANTY IS ISSUED AND ACCEPTED IN LIEU OF ANY AND ALL OTHER EXPRESS OR IMPLIED WARRANTIES OF ANY KIND OR NATURE AND EXPRESSLY EXCLUDES LIABILITY FOR LABOR, FREIGHT AND OTHER COSTS ASSOCIATED WITH REMOVAL AND REPLACEMENT OF THE DEFECTIVE PRODUCT AND FOR INDIRECT AND CONSEQUENTIAL DAMAGES

Due to variations in the printing and photographic processes, actual appearance and color of our products may differ from the appearance reflected in this website or in any of our brochures or other product literature and appearance and color may differ from one brochure or other product literature to the next. Please be advised that this warranty does not cover those appearance and color variations.

Once installed, our products are deemed accepted in terms of surface texture, shape, size, split face geometry, color, color blending and all other aesthetic features.

Manufactured by:



keystonehardscapes.com

FOLLOW US



©2024 The QUIKRETE Companies - Patents Pending. • KHS - 1/2024

QUIKRETE and its subsidiaries (collectively QUIKRETE) reserve the right to improve its products and make changes to its specification and design without notice. The information contained herein has been compiled by QUIKRETE and to the best of its knowledge, accurately represents Keystone Hardscapes products and how they may be used in the applications which are illustrated. Site conditions, including load pressures acting on the wall, soil types and drainage conditions, may vary. Final determination of the suitability of the product for the use contemplated and the manner of product use are the sole responsibility of the user. Good construction practices and local building codes require the use of an engineered design when constructing retaining walls or freestanding walls in many conditions. Structural design and analysis should be provided by a qualified engineer.